

Block 6

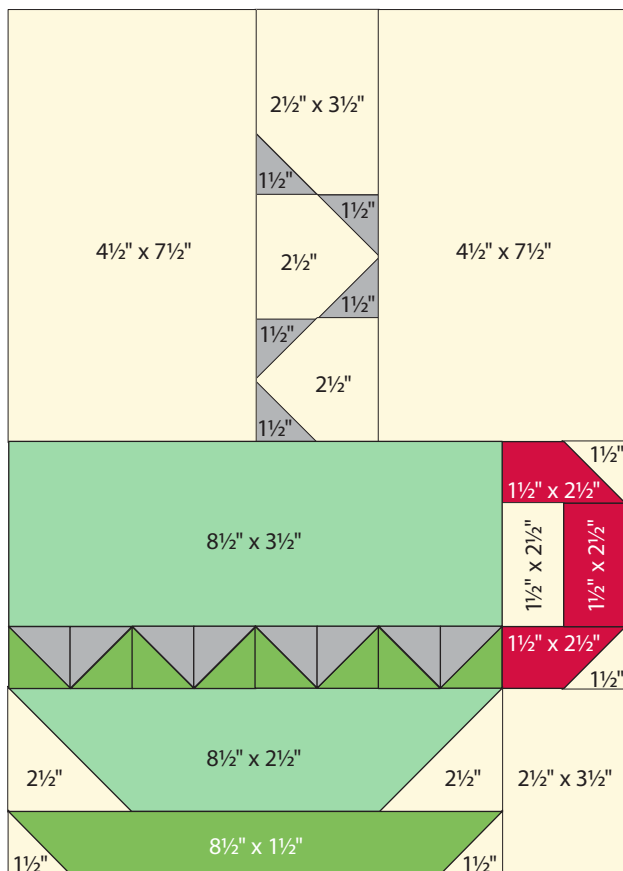

10½" x 14½" with seams.

Cutting

From the Layer Cake™ prints:

Cup top: 1-8½" x 3½"

Half square triangle units:

4-2" squares Print 1

4-2" squares Print 2

Cup bottom: 1-8½" x 2½"

Handle: 3-1½" x 2½"

Saucer: 1-8½" x 1½"

These pieces were cut on page 2:

Steam: 5-1½" squares

Cup Background: 4-1½" squares

1-1½" x 2½"

4-2½" squares

2-2½" x 3½"

2-4½" x 7½"



- 1 Make the Small Handle (page 23).
- Make the Saucer (page 24).
- Make the Steam (page 25).



- 2 Make 8-1/2" half square triangle units (page 24).
- Combine the 8 half square triangles units as shown.



Cup center.

- 3 Draw a diagonal line from corner to corner on the wrong side of 2-2 1/2" Cup Background squares. Layer 1-2 1/2" Cup Background square, right sides together, on each end of 1-8 1/2" x 2 1/2" Cup bottom as shown. Sew on the diagonal line. Trim 1/4" from the diagonal line. Press to the corner to form the triangle.

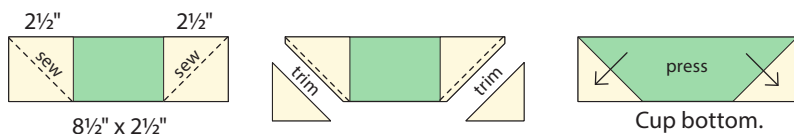

- 4 Assemble the Cup as shown. Press in the directions of the arrows.

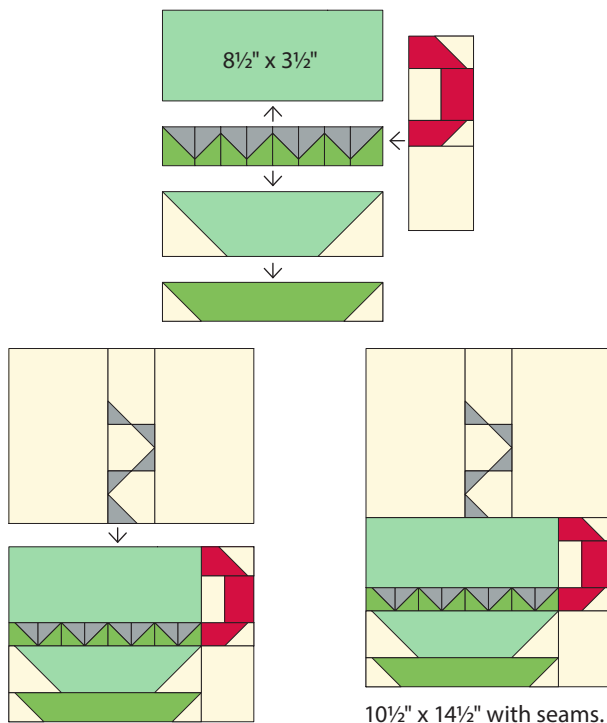

10 1/2" x 14 1/2" with seams.